

SHADOWCAT				
Hardware				
NUMBER	PART NUMBER	DESCRIPTION	TORQUE	*
3	FP-UDH-TA-12MM-BLK-V1-R1	Universal Rear Derailleur Hanger		
4	-	Universal Rear Derailleur Bolt	25 Nm (18 lb·ft)	
5	-	Universal Rear Derailleur Hanger Washer		
6	FP-LNK-UL-67.2-V1-R1	67.2mm Upper Link		
7	FP-LNK-LL-BLK-V3-R1	34mm Out-to-Out Lower Link		
8	FP-BRG-6902-LLUMAXECN	28mm 6902 Extended Race Bearing		R
9	FP-BRG-6900-LLUMAXE	22mm 6900 Extended Race Bearing		R
10	FP-BLT-M8*45.7-BLK-V2	M8 Front Shock Bolt for 30.1mm Shock Spacing	13 Nm (10 lb·ft)	G / L
11	FP-BLT-M14*20-BLK-V2-R2	M14x20 Link Bolt	35 Nm (27 lb·ft)	L
12	FP-BLT-M14*17-BLK-V1-R2	M14x17 Link Bolt	35 Nm (27 lb·ft)	L
13	FP-BLT-M10*16.5-BLK-V1	M10 Trunnion Mount Bolt	13 Nm (10 lb·ft)	L
14	FP-CLM-MECH-FRM-V1	Internal Routing Cable Clamp		
15	FP-CVR-MECH-FRM-V2	Internal Routing Hole Cover		
16	FP-CLM-DUAL-FRM-V1	Internal Routing Dual Clamp		
17	FP-SCW-FLT-M3*10	M3x10 Cable Clamp Screw (Included w/ Clamp)		
18	FP-PLG-DI2-7*8*2.5	7x8mm Di2 Plug		
19	FP-GDE-DI2-7*8*2.5*2.5	7x8mm Di2 Wire Guide		
20	FP-CVR-FLV-TT-V1-R1	Fox Live Cover Plate		
21	FP-WSH-FLV-CNTRLMT-V1-R1	Fox Live Controller Mount Spacer		
22	FP-CVR-FLV-ACC-V1-R1	Fox Live Accelerometer Cover		
23	FP-MNT-TOOL-BLK-V1-R1	Topeak Tool Mount		
24	FP-SCW-FLT-M5*16	M5x16 Topeak Tool Mount Screws		
25	FP-MNT-TLPLG-BLK-V1-R1	Topeak Tool Mount Plug		
26	FP-PRO-SCTV1-DT-XS-V1-R1	M55Cv2 Downtube Protector (XS)		
26	FP-PRO-SCTV1-DT-S/M/L-V1-R1	M55Cv2 Downtube Protector (SM/MD/LG)		
27	FP-PRO-SCTV1-CS-V1-R1	M55Cv2 Chainstay Protector		
28	FP-PRO-SCTV1-SS-V1-R1	M55Cv2 Seatstay Protector		
29	FP-PRO-SCTV1-UR-V1-R1	M55Cv2 Upright Protector		
30	PIVOT WB BOLTS V2	M5x0.8x18 Nickel Plated Steel Water Bottle Bolts		
31	FP-PRO-34MM-LL-V2-R1	34mm Lower Link Protector		
32	FRAME SIZE STICKER - XS/SM/MD/LG/XL	Frame Size Sticker		
Axles				
NUMBER	PART NUMBER	DESCRIPTION	TORQUE	*
101	148MM THROUGH AXLE V4	148mm UDH Rear Axle	15 Nm (11 lb·ft)	G
102	-	12mm Axle Washer (Included w/ Axle)		
Bike Care				
*	PRODUCT TYPE	RECOMMENDED PRODUCT		
G	Grease	Motorex Bike Grease 2000		
L	Thread Locker**	Loctite Thread Locker #243 (or equivalent)		
G/L	Grease (Bolt Shaft) / Thread Locker (Bolt Threads)	See Above		
A	Anti-Seize	Motorex Copper Paste		
R	Retaining Compound	Loctite Retaining Compound #620 (or equivalent)		

**Threadlocker should always be applied to the corresponding female threads for the bolt specified

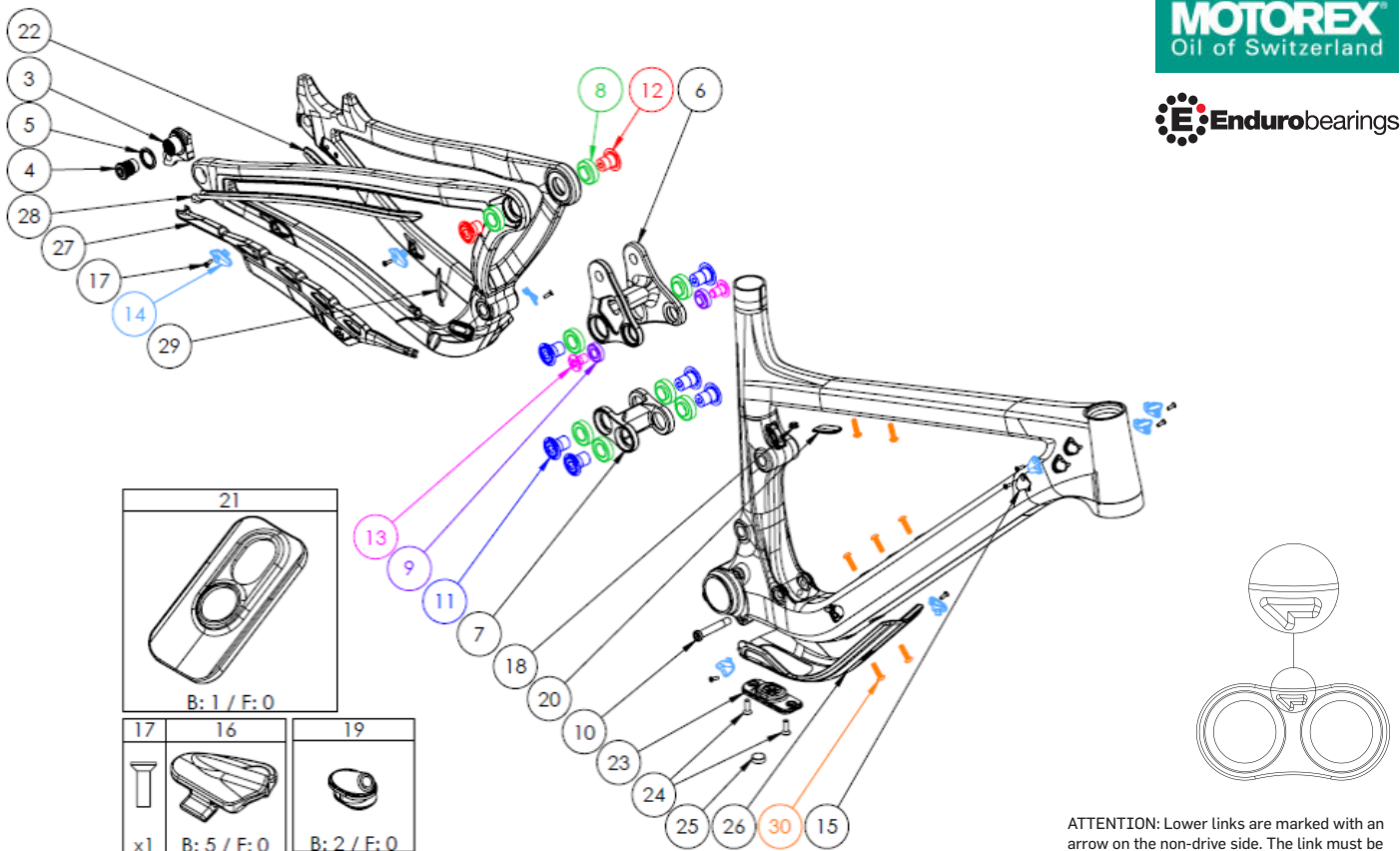

ATTENTION: Lower links are marked with an arrow on the non-drive side. The link must be oriented where the arrow points to the front triangle.

