



ISO FLEX TECHNOLOGY

The Vault uses Pivot's patented ISO FLEX Technology. This frame feature completely isolates the seat-post from the frame for extraordinary comfort without compromising the frames stiffness and control. This guide will walk you through the steps to remove and install the insert for maintenance.

TABLE OF CONTENTS	PAGE
1. ISO FLEX Schematic and Parts	1
2. ISO FLEX Removal	2
3. ISO FLEX Installation	3



Exploded view of the ISO FLEX Technology and the corresponding individual parts.

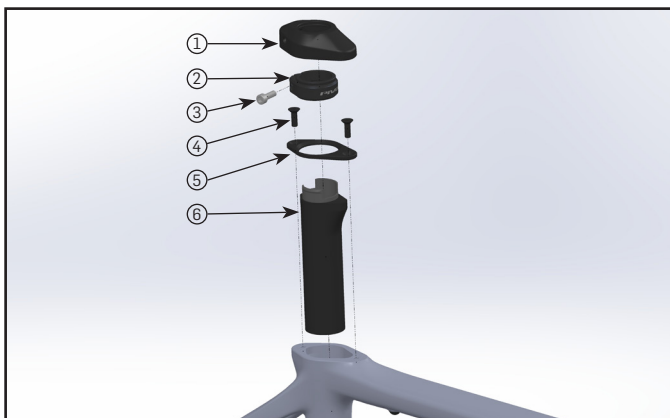

#	Part Number	Description
1	FP-ISOFLEX-RUB-CAP-V1	Seat Post Clamp Rubber Cap
2	FP-CLM-FLXPOST-27.2-V2-R1	27.2mm Seat Post Clamp
3	FP-SCW-SCK-M5*15	Seat Post Clamp Screw
4	FP-SCW-FLT-M5*15	M5x15 Flat Head Top Cap bolts
5	FP-ISOFLEX-TOP-PLT-V	Seat Post Top Plate
6	FP-SLV-STPOST-27.2-V2-R1	27.2mm Seat Post Insert



1.) Slide the Seat Post Clamp Cap off of the seat post clamp and up the seat post to give you space to loosen the Seat Post Clamp Screw.



2.) Loosen the Seat Post Clamp Screw with a 4mm hex wrench and remove the seat post.



3.) Slide the Seat Post Clamp up off the ISO FLEX insert to access the Top Cap Bolts.



4.) Loosen and remove the Top Cap Bolts and the Top Plate.



5.) Re-install the seat post and the seat post clamp. Tighten the seat post clamp bolt on the ISO FLEX insert. *Clamping the seat post in a bike stand can make the process easier.*



6.) Pull down on the frame to remove the ISO FLEX insert from the frame. *This is a tight fit and may require some rocking the frame back and forth to release it from the frame.*

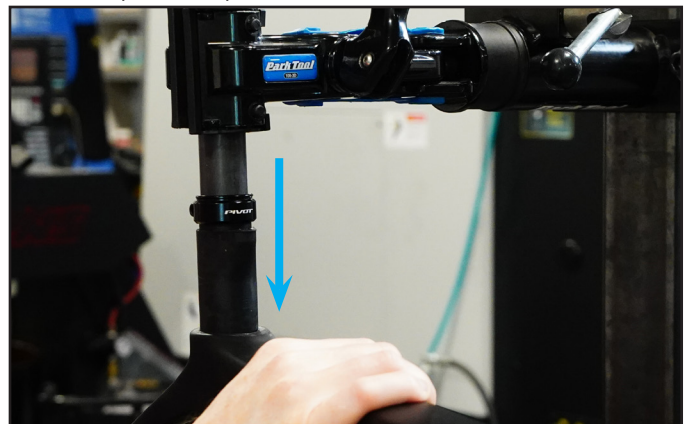



1.) Grease the insert with a rubber or silicone safe grease.



2.) Gently press down on the ISO FLEX insert to place it down into the frame.



3.) Grease the Top Cap Bolts' threads and heads.



4.) Place the Seat Post Top Plate over the ISO FLEX insert and thread in the bolts.



5.) Torque the Top Cap Bolts to 5 Nm.



6.) Install the Seat Post Clamp on the ISO FLEX insert.





7.) Slide the Seat Post Clamp Rubber Cap onto the seatpost if it was removed.



8.) Apply some grease to the seat tube and insert the seat post into the frame.



9.) Slide the Seat Post Clamp Rubber Cap down over the Seat Post Clamp.



10.) There is an opening in the Rubber Cap to access the Seat Post Clamp screw. Torque the Seat Post Clamp Screw to 5Nm.



11.) Confirm saddle height and position measurements.



12.) Installation is complete.

